

LIGHT SOURCES

120W HID short arc light source For medical & industrial applications

Intense white light from a cool, compact, rugged design. Ideal for medical, surgical, dental, and industrial lighting applications

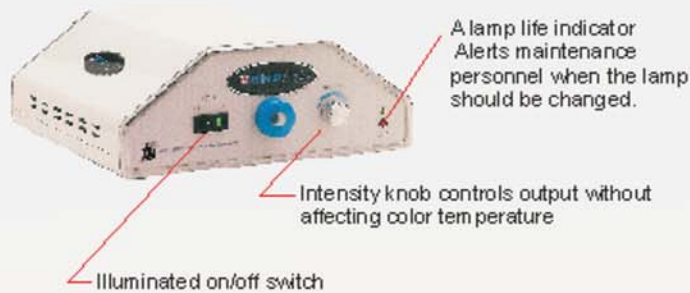

Power Supply Specifications	
Maximum Rated Power Output	200 watts
Output Voltage	85volts (SQ wave)
Input voltage rating 60 Hz	100-120 VAC
Input voltage rating 50 Hz	230-240 VAC
Leakage Current 60 cycle	<100mA
Leakage Current 50 cycle	<300mA
Illuminating Aperture	Up to 6.00mm
Current Limit Set point	2.5 Amps
Temperature Range: Operating	0° to 60° C
Storage	-18° to 60° C
Relative humidity, Non Condensing	0% -to 95%

* Specifications are subject to change without notice

OPTIONS

- 5 caster (Locking) floor stand and cable holder
- Special Adapters for ACMI, Olympus, Pilling, general industrial lighting.
- 50C/220 V operation

P/N	Description	Voltage/ Cycles	Lamp Type
FTIHL17521	120W, 115V HID Light source	115/60	HID
	120W, 230V HID Light source	230/50	HID



Xenonlight

FEATURES

- HID short arc output provides 6000°K color adjusted output with little change over the life of the lamp. Just as intense as 300W Xenon, 20x brighter than Quartz Halogen!
- 1250 hr. lamp operating life. Lamp change indicator on the front panel alerts user when lamp should be changed.
- Manually operated gradient screen controls intensity without sacrificing color temperature.
- Choose from a range of input adapters: Storz (Standard), Olympus, Pilling, ACMI, Wolf, and an industrial adapter designed to accept our industrial light guides. Regardless of which is chosen, the input stays cool to the touch.
- Lighted power switch provides "power-on" indication at glance from a distance.
- Hospital safety plug for secure connections.
- 1 year warranty.
- CE (IEC 601-1), UL(2601) certified as Class I equipment, type BF continuous operation. Not suitable for use near flammable anesthetic mixtures.
- FDA Class II product.
- Overall Height: 4.5" (114 mm)
- Overall Width: 10.5" (267 mm)
- Overall Depth: 11" (280 mm)
- Unit Weight: 6.85lbs. (3.1 kg) including cord.

CORPORATE HEADQUARTERS



fiberoptics technology incorporated
EST. 1977

1Fiber Road, Post Office Box 286, Pomfret, Connecticut 06258
PHONE 800.433.5248 • FAX 860.928.7664 • WEBSITE: www.fiberoptix.com • E-MAIL: info@fiberoptix.com

LAMPS and ACCESSORIES

Replacement lamps



P/N	Description
FTIHL17539	Xenalight replacement lamp
FTIHL17540	Xenalight replacement lamp with cartridge

Floor Stand

- 5 swiveling casters, two locking.
- Swivel base.
- 3 position height adjustment with locking pin
- Headlight and light guide hangers.

P/N	Description
FTIHL17523	Xenalight Floor Stand



5 caster (2 lockable) stand.

Optional Input Ports

P/N	Description
FTIHL17528	ACMI I input port for Xenalight
FTIHL17529	Olympus input port for Xenalight
FTIHL17530	Pilling input port for Xenalight
FTIHL17531	Wolf input port for Xenalight
FTIHL17532	Industrial input port for Xenalight



CORPORATE HEADQUARTERS

fiberoptics technology incorporated
EST. ABOLISHED 1977

1Fiber Road, Post Office Box 286, Pomfret, Connecticut 06258
PHONE 800.433.5248 • FAX 860.928.7664 • WEBSITE: www.fiberoptix.com • E-MAIL: info@fiberoptix.com